



28 President Road Kellyville NSW

6 2 5

With a layout offering flexibility to suit many different family configurations, this property is a unique offering in the Kellyville market. Located on a 697 sqm corner block and within walking distance to Kellyville Primary and High Schools, plus Kellyville Village Shopping Centre this home is well located for a large or extended family.

Featuring:

- Recently updated kitchen with stone benchtops, quality stainless steel appliances and ample pantry and storage cupboards
- Open plan meals and living room, plus large family room
- Six generous size bedrooms - three upstairs and three downstairs - plus built in robes and dual linen closets
- Two recently renovated bathrooms, both with separate W/C and full laundry room
- Undercover alfresco area overlooking the inground

Price : \$ 1,100,000

Land Size : 697 sqm

View : <https://www.theavenuerealestate.com.au/4760738>



Chris De Celis
02 9634 3444

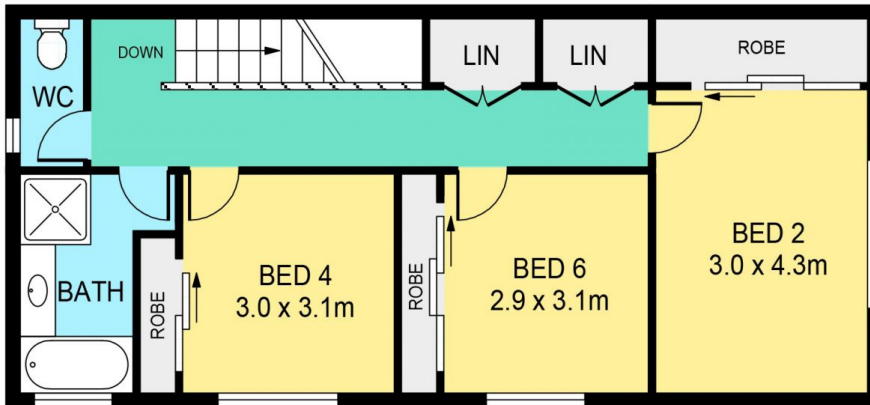
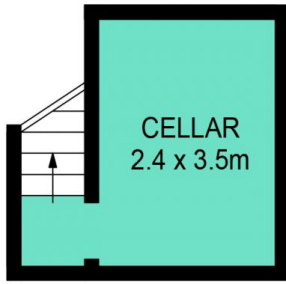

FIRST FLOOR

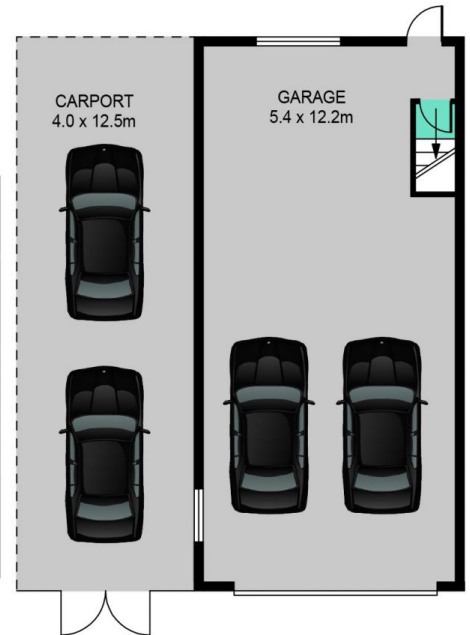

GROUND FLOOR

28 PRESIDENT AVENUE, KELLYVILLE

DISCLAIMER:

PLANS SHOWN ARE FOR MARKETING PURPOSES ONLY. ALL DIMENSIONS ARE APPROXIMATE AND NOT TO SCALE. THEY ARE SUBJECT TO ERRORS AND INACCURACIES AND NO LIABILITY WILL BE ACCEPTED. INTERESTED PARTIES SHOULD MAKE THEIR OWN INQUIRIES.