

### 19 Cornelius Place Kellyville NSW

5 3 3

Positioned in a quiet cul-de-sac on a 600sqm block, is this large family residence, offered for the first time to the market. With manicured gardens, generous living and entertaining areas, plus a triple car garage, this home has many features that are highly prized, yet rarely found.

#### Featuring:

- Large central kitchen with quality appliances, Caesarstone benchtops, walk in pantry and large additional storage cupboards
- Formal lounge and dining rooms at the front of the house, with informal and relaxed living at the rear
- Grand foyer and entryway with double doors and high ceilings
- Four bedrooms upstairs, including a Master bedroom retreat with walk in robe and ensuite bathroom and upstairs rumpus room

**View :** <https://www.theavenuerealestate.com.au/4802703>



**Chris De Celis**  
**02 9634 3444**

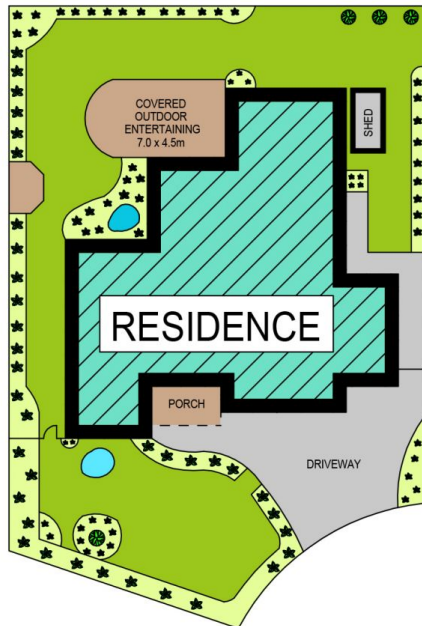

SITE PLAN



GROUND FLOOR

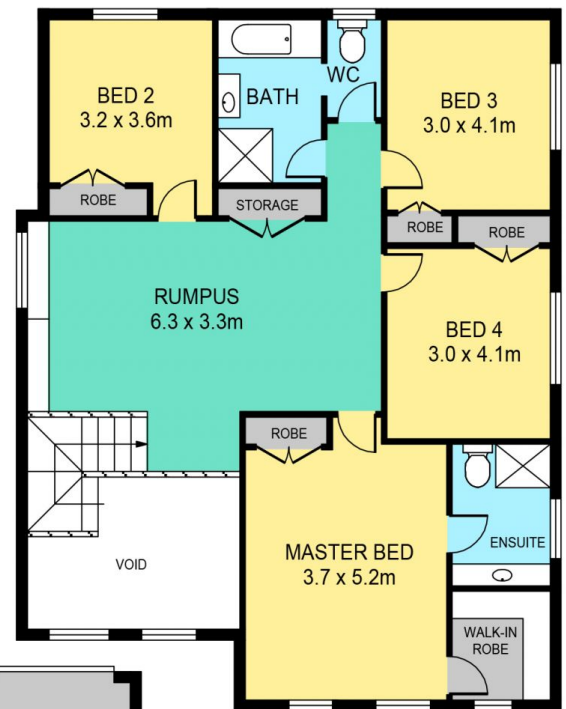

FIRST FLOOR

## 19 CORNELIUS PLACE, KELLYVILLE

**DISCLAIMER:**

PLANS SHOWN ARE FOR MARKETING PURPOSES ONLY. ALL DIMENSIONS ARE APPROXIMATE AND NOT TO SCALE. THEY ARE SUBJECT TO ERRORS AND INACCURACIES AND NO LIABILITY WILL BE ACCEPTED. INTERESTED PARTIES SHOULD MAKE THEIR OWN INQUIRES.