



**5 Castle Pines Drive Norwest NSW**

3 2 2

This stunning single level villa enjoys picture-perfect views over the lake and esteemed fairways of the magnificent Castle Hill Golf Course.

Set in the prized Castle Pines Over 55's Strata Estate it offers a real lifestyle opportunity with generous free flowing living areas and private gardens designed to maximise space and natural light. Featuring:

- Generous bedrooms with en-suite to master
- Tranquil easy-care alfresco entertaining and gardens
- Open plan gas kitchen
- Spacious 135m2 internal living
- Double auto garages Plus separate golf buggy space
- Private, peaceful and secure estate
- Community clubhouse, swimming pool and tennis court
- Conveniently close to Norwest train station and shopping

**Price** : \$ 1,100,000  
**Building Size** : 135 sqm  
**Land Size** : 330 sqm  
**View** : <https://www.theavenurealestate.com.au/4802706>



**Chris De Celis**  
02 9634 3444

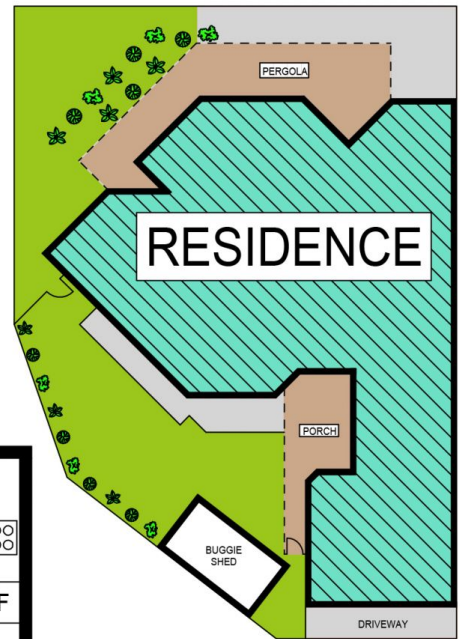

SITE PLAN

## 5 CASTLE PINE DRIVE, NORWEST

**DISCLAIMER:**

PLANS SHOWN ARE FOR MARKETING PURPOSES ONLY. ALL DIMENSIONS ARE APPROXIMATE AND NOT TO SCALE. THEY ARE SUBJECT TO ERRORS AND INACCURACIES AND NO LIABILITY WILL BE ACCEPTED. INTERESTED PARTIES SHOULD MAKE THEIR OWN INQUIRES.