



6 Tamara Place Beaumont Hills NSW

4 2 2

Situated in one of Beaumont Hills most desirable cul-de-sac locations, this impressive family home on a generous 600m² block is perfect for the growing family. Open plan family and meals area off the kitchen flows seamlessly onto the undercover outdoor area overlooking fully landscaped gardens which provides the perfect place to entertain.

Commanding street appeal with an extra wide frontage including side gate access, perfect for the boat, camper or trailer.

Features include:

- ? Four good-sized bedrooms all with built ins
- ? Main with ensuite and walk in robe

Price : \$ 1,250,000
Land Size : 600 sqm
View : <https://www.theavenuerealestate.com.au/4813691>



Steve Cole
02 9634 3444

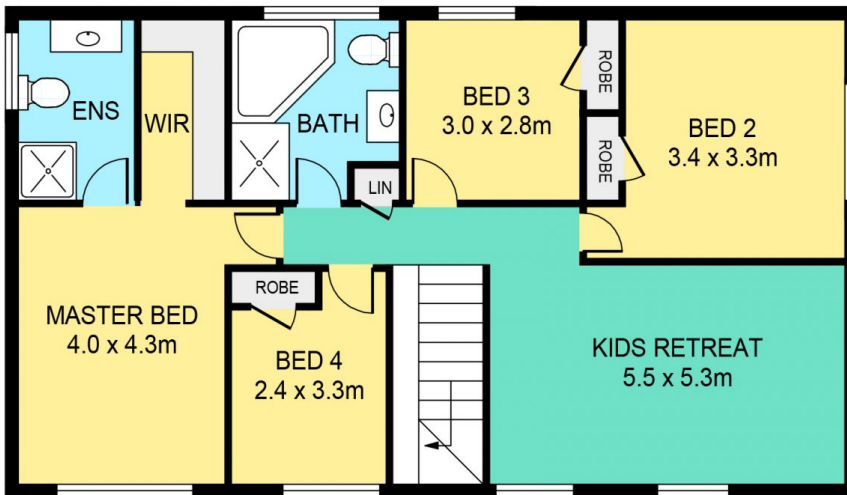

FIRST FLOOR

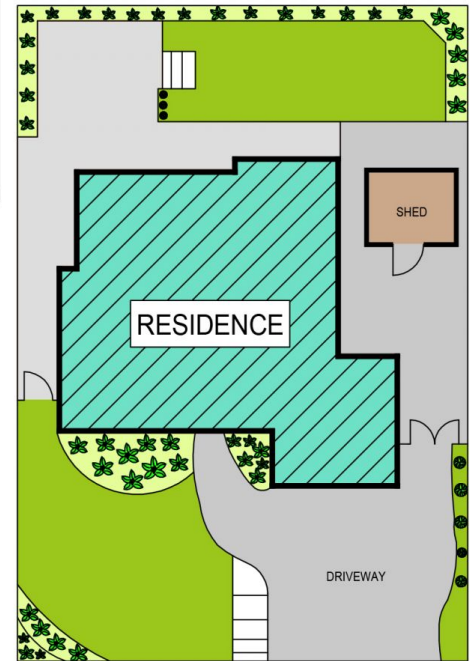

SITE PLAN



GROUND FLOOR

6 TAMARA PLACE, BEAUMONT HILLS

DISCLAIMER:

PLANS SHOWN ARE FOR MARKETING PURPOSES ONLY. ALL DIMENSIONS ARE APPROXIMATE AND NOT TO SCALE. THEY ARE SUBJECT TO ERRORS AND INACCURACIES AND NO LIABILITY WILL BE ACCEPTED. INTERESTED PARTIES SHOULD MAKE THEIR OWN INQUIRES.