



30 Gainsford Drive Kellyville NSW

4 2 2

This stylish, single level property is located in the heart of Kellyville and a short walk to the upcoming Kellyville Train Station. With a thoughtful and practical floorplan, north-easterly living area aspect and stunning established gardens with greenery glimpses from every window plus a very private landscaped backyard, this property is perfect for a family large or small.

Featuring:

- Entertainers kitchen with central long island, 900mm freestanding cooker, large walk in pantry, stone benchtops and lots of storage space
- Large open plan lounge and dining rooms adjacent to the kitchen, plus study and rumpus rooms, offering flexibility
- Master bedroom with large walk in robe and designer ensuite bathroom with double vanity
- Three other generous bedrooms, all with built in robes

View : <https://www.theavenuerealestate.com.au/4890502>



Chris De Celis
02 9634 3444

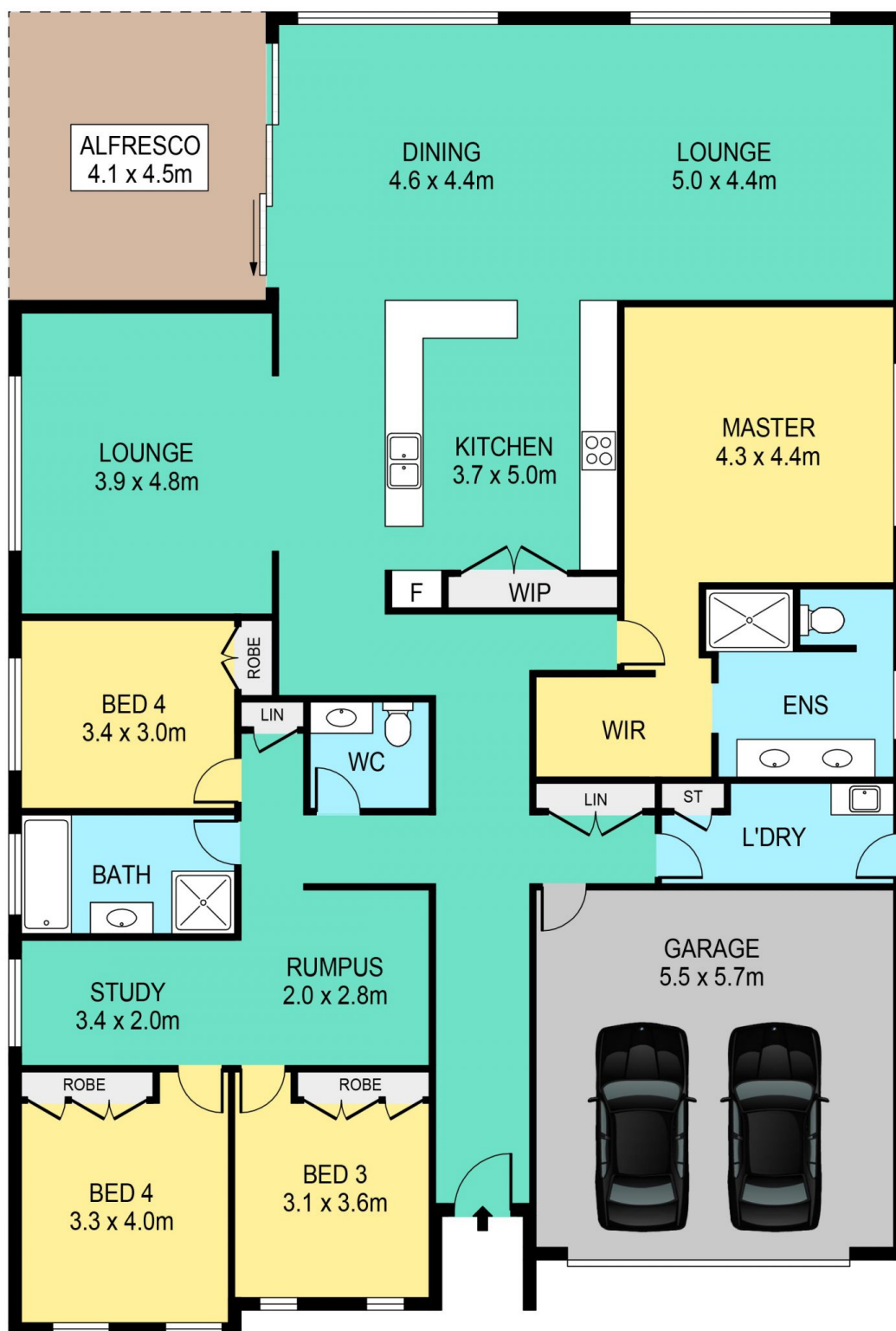

30 GAINSFORD AVENUE, KELLYVILLE

INTERNAL 224m²
EXTERNAL 18.5m²
APPROXIMATE SIZES

DISCLAIMER:

PLANS SHOWN ARE FOR MARKETING PURPOSES ONLY. ALL DIMENSIONS ARE APPROXIMATE AND NOT TO SCALE. THEY ARE SUBJECT TO ERRORS AND INACCURACIES AND NO LIABILITY WILL BE ACCEPTED. INTERESTED PARTIES SHOULD MAKE THEIR OWN INQUIRIES.