



Nina Disano
Senior Property Manager
M 0418 327 758



25 Doreen Crescent Baulkham Hills NSW

3 1 2

This mid-century family home, filled to the brim with character and charisma contains all your family desires! Positioned on a 701m2 block and within the catchment areas for Jasper Road Public School and Crestwood High School, nearby to Stockland Mall and Arthur Street shops and with public transport options only a short walk away, this property is well located to take advantage of the lifestyle and community in The Hills.

Land Size : 701 sqm
View : <https://www.theavenurealestate.com.au/5739522>

Featuring:

- Brand new carpet throughout
- Open plan family, lounge and dining rooms
- U-shaped kitchen overlooking the backyard
- Three generous bedrooms, all with built-in robes
- Large family bathroom with separate shower and bath
- Internal laundry with access to the backyard
- Large undercover pergola overlooking the grassy rear



Chris De Celis
02 9634 3444

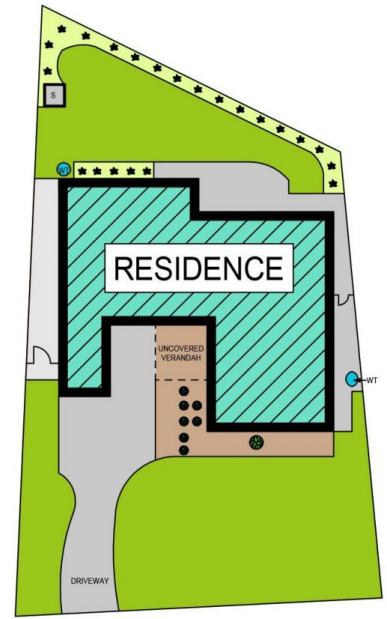
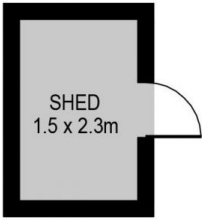

SITE PLAN



25 DOREEN CRESCENT, BAULKHAM HILLS

DISCLAIMER:

PLANS SHOWN ARE FOR MARKETING PURPOSES ONLY, ALL DIMENSIONS ARE APPROXIMATE AND NOT TO SCALE. THEY ARE SUBJECT TO ERRORS AND INACCURACIES AND NO LIABILITY WILL BE ACCEPTED. INTERESTED PARTIES SHOULD MAKE THEIR OWN INQUIRIES.