



6 Macarthur Ridge Way Bella Vista NSW

4 2 4

(Inspections Available By Appointments)

Macarthur Ridge is an exclusive collection of architecturally designed luxury homes.

This attractive family home, situated in an enviable small community, is ideal for those who are after an executive lifestyle with all modern living amenities in the Bella Vista precinct.

Benefiting from the easterly aspect to the front, there's plenty of natural light everybody loves. Enjoy your cup of coffee, either on the large balcony off the living room or the private alfresco area, adjacent to Bella Vista farm.

In addition to the large living and family area on the ground level, there's a fourth bedroom and a spacious

Price : \$ 1,885,000
Land Size : 557 sqm
View : <https://www.theavenuerealestate.com.au/6487736>



Soha Soheili
02 9634 3444



Sherry Soheili
0406 048 133

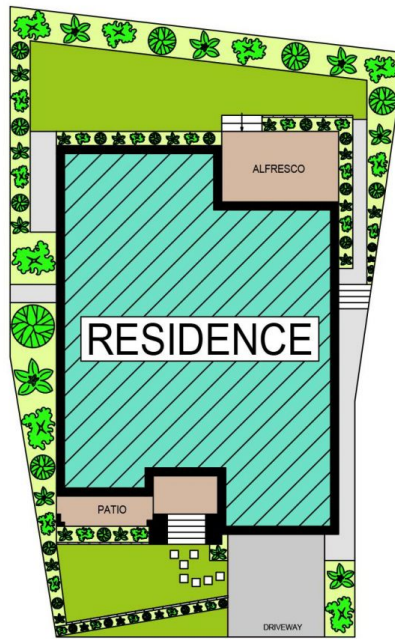

SITE PLAN

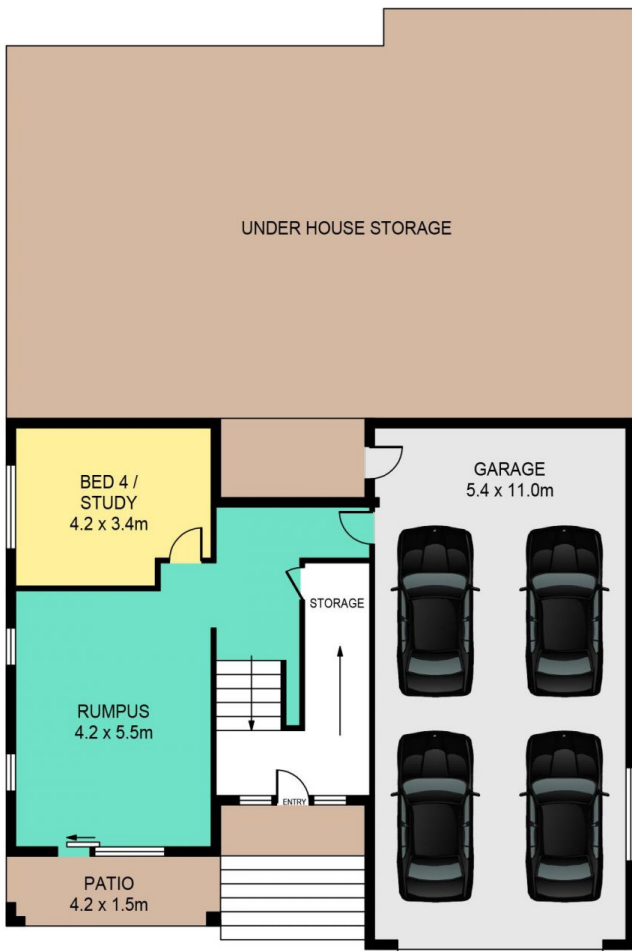

GROUND FLOOR

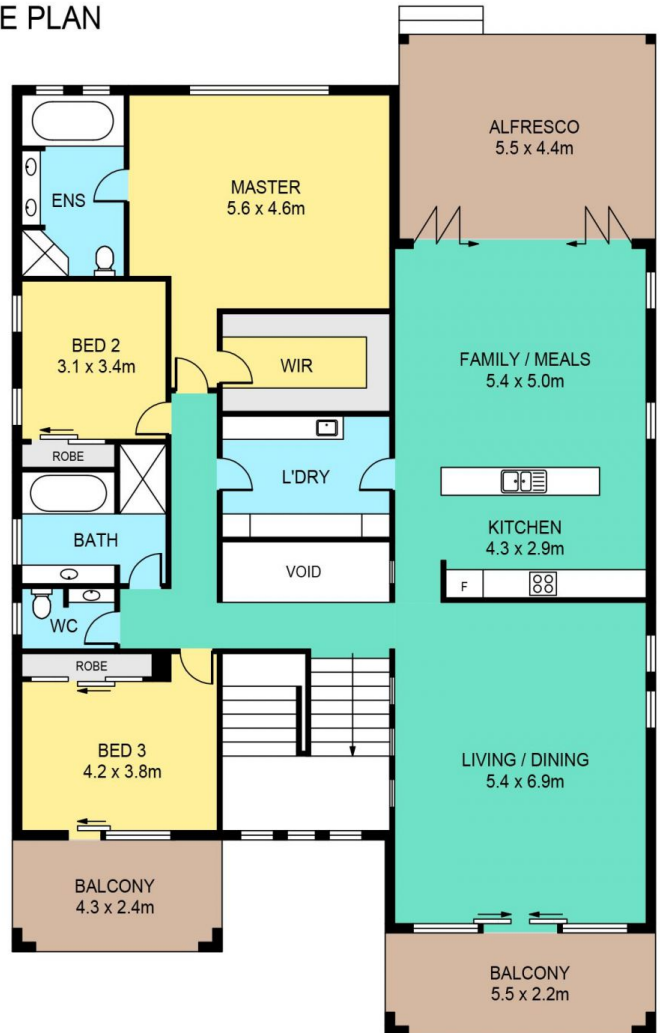

FIRST FLOOR

6 MACARTHUR RIDGE WAY, BELLA VISTA

DISCLAIMER:

PLANS SHOWN ARE FOR MARKETING PURPOSES ONLY. ALL DIMENSIONS ARE APPROXIMATE AND NOT TO SCALE. THEY ARE SUBJECT TO ERRORS AND INACCURACIES AND NO LIABILITY WILL BE ACCEPTED. INTERESTED PARTIES SHOULD MAKE THEIR OWN INQUIRIES.